





Commercial, Leg Street, Oswestry, Shropshire, SY11 2NN
£500

A well-positioned double fronted commercial premises in Oswestry town centre.



31 Leg Street presents an excellent commercial opportunity, benefiting from close proximity to a range of established local businesses.

Energy Rating B. A three year lease is preferable.

Rent £500pcm
Deposit: £1,800
Holding Deposit £110

One large space with double fronted windows

20'5" x 19'6" (6.23 x 5.95)

WC

4'5" x 5'1" (1.37 x 1.55)

Kitchen area

3'2" x 5'1" (0.99 x 1.55)

Total floor area

37 square metres

Viewings

By appointment only through Roger Parry & Partners

Holding Deposit

PLEASE READ: Before your application can be fully considered, you will be required to pay Roger Parry & Partners a holding deposit equivalent to one week's rent for the property you wish to apply for. You are advised to familiarise yourself with your legal rights and may wish to seek independent legal advice before signing this or any other document provided by us. Once the holding deposit has been received, current legislation allows a maximum of 15 days for the necessary paperwork to be completed. This period may only be extended by written agreement between both parties. The holding deposit may be retained in the following circumstances:

- If you decide not to proceed with the tenancy during the 15-day period
- If you unreasonably delay responding to reasonable requests from Roger Parry & Partners or Rightmove Landlord & Tenant Services
- If you provide false or misleading information as part of your application
- England only - If you fail the checks the Landlord is legally required to carry

out under the Immigration Act 2014 (Right to Rent)

In these circumstances, the holding deposit will be retained by Roger Parry & Partners and the Landlord.

If the Landlord decides not to proceed with the tenancy for reasons unconnected with the above, the holding deposit will be refunded within seven days.

If you are offered a tenancy and you accept it, the holding deposit will be credited towards the first month's rent.

Where the holding deposit is neither refunded nor credited, you will be provided with written reasons within seven days explaining why it has been retained.

By submitting your application, you agree to pay any such permitted fees if they become due.

Floor Plan
(not to scale - for identification purposes only)

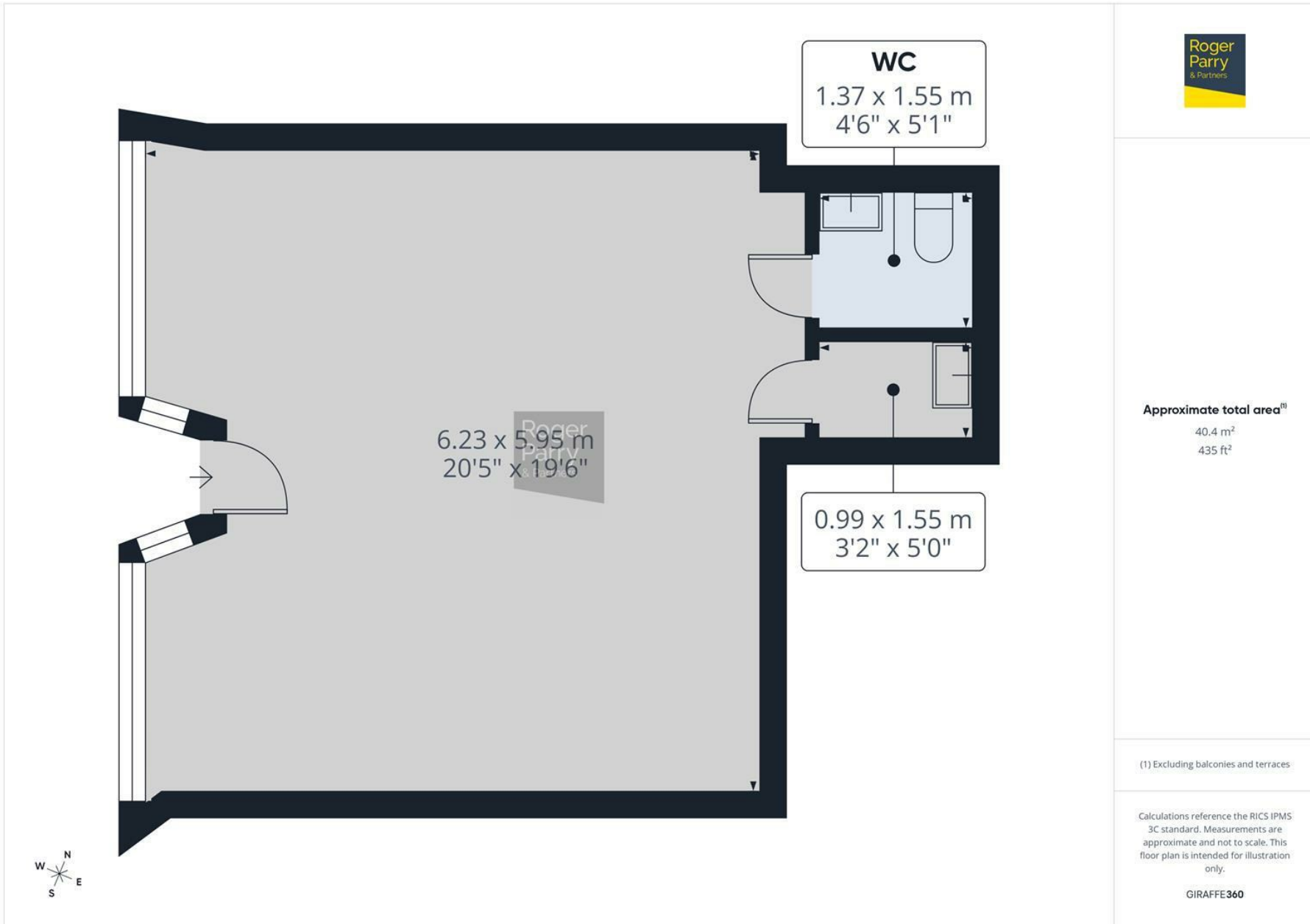

General Services:

Local Authority:

Council Tax Band: New Build

EPC Rating:

Tenure:

Fixtures and fittings: No fixtures and fittings are necessarily included in the sale unless agreed at point of sale or point of subsequent negotiations.

Wayleaves, rights of way and easements: The property will be sold subject to and with the benefit of all wayleaves, easements, and rights of way, whether mentioned in these particulars or not.

Directions:

Viewing arrangements

Viewing of the property is strictly by appointment only through:

Roger Parry & Partners LLP

Please contact our Shrewsbury Office:
165 Frankwell, Shrewsbury, Shropshire, SY3 8LG
shrewsbury@rogerparry.net

01743 343343



Important Notice: 1. Nothing in these particulars shall be deemed to be a statement that the property is in good structural condition or otherwise nor that any of the services, appliances, equipment or facilities are in good working order. Purchasers should satisfy themselves of this prior to purchasing. 2. Any areas, measurements, aspects or distances referred to are given as a GUIDE ONLY and are NOT precise. If such details are fundamental to a purchase, purchasers must rely on their own enquiries. 3. Descriptions of the property are subject and are used in good faith as an opinion and NOT as a statement of fact. Please make further enquiries to ensure that our description is likely to match any expectations you may have. 4. Where any references are made to planning permission or potential uses such information is given by Roger Parry & Partners in good faith. Purchasers should make their own enquiries into such matters prior to the purchase. 5. The photograph(s) depict only certain parts of the property. It should not be assumed that any contents/furniture etc. photographed are included in the sale. It should not be assumed that the property remains as displayed in photograph(s). No assumptions should be made with regards to parts of the property that have not been photographed. 6. These sale particulars have been prepared in all good faith to give a fair overall view of the property. If any points are particularly relevant to your interest in the property, please ask for further information.